



HEALTH SECTOR

TEHSIL HEADQUARTERS HOSPITAL

REQUIREMENTS ARE BASED ON STANDARDS GIVEN IN THE

NATIONAL REFERENCE MANUAL ON PLANNING & INFRASTRUCTURE STANDARDS



HEALTH FACILITIES

TEHSIL HEADQUARTER HOSPITAL (60 BEDS) – REQUIREMENTS/ COST

STAFF	No.	REQUIREMENTS/COST	AREA
1. Specialists	05	1. Medical Superintendent	240 SFT
2. Doctors	10	2. Specialists (05)	1,000 SFT
3. Dental Surgeon	01	3. Doctors (10)	1,850 SFT
4. Nurses	12	4. Dental Surgeon (01)	185 SFT
5. Midwives/ Maids	15	5. LHV/Sanitary /Radiographer /Admin	1,100 SFT
6. Sanitary Inspectors	04	6. O.P.D	4,050 SFT
7. Lady health Visitors	03	7. Casualty (Complete)	1,075 SFT
8. Radiographers	02	8. X-Ray / Lab / Blood Bank / ECG/ Labor Suite + Twin O.Ts	7,300 SFT
9. Pharmacist / Dispensers	04	10. Stores/ Laundry/ Mortuary/Kitchen	4,000 SFT
10. Technicians	16	11. Staff Toilet	1,200 SFT
11. Administrative Staff	08	12. Patient Toilet	1,200 SFT
12. Other Staff	60		
Total Staff	140	Total	23,200 SFT
Distribution of 60 beds		Circulation Space + Wall	7,120 SFT
Medical	15	Sub Total Area	30,320 SFT
Surgical	15	Wards: Two 30 Bed wards with 20% of beds in Single rooms	7,680 SFT
Pediatrics	12		
Obstetrics and gynaecology	12	TOTAL COVERED AREA	38,000 SFT
Isolation	06		
Total	60		



HEALTH FACILITIES

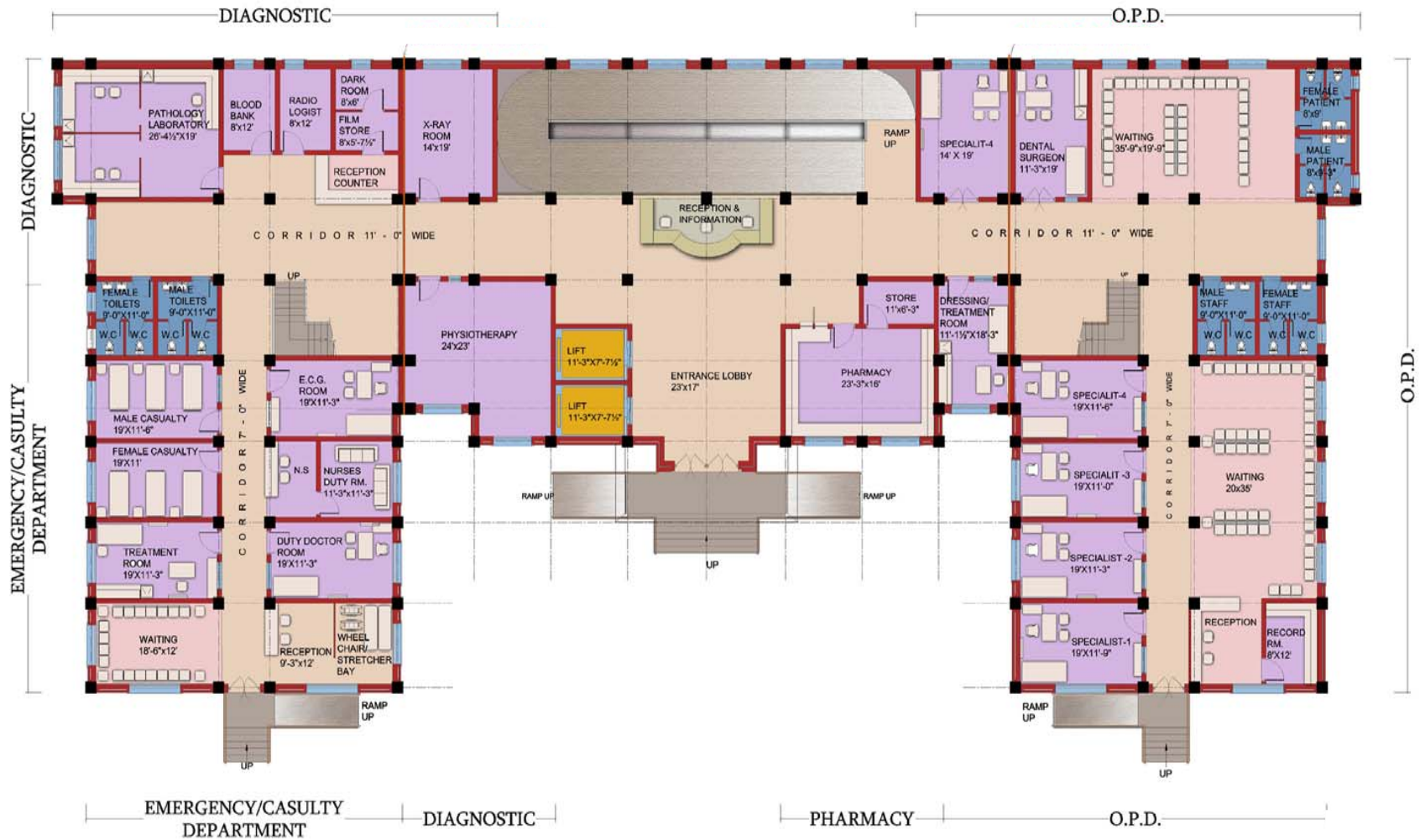

GROUND FLOOR PLAN
COVERED AREA = 13000 sqft.

General note :
 Design may be adjusted due to following parameters

1. Seismic parameters
2. User requirement
3. Site parameters

TYPICAL DESIGN - TEHSIL HEADQUARTER HOSPITAL



HEALTH FACILITIES

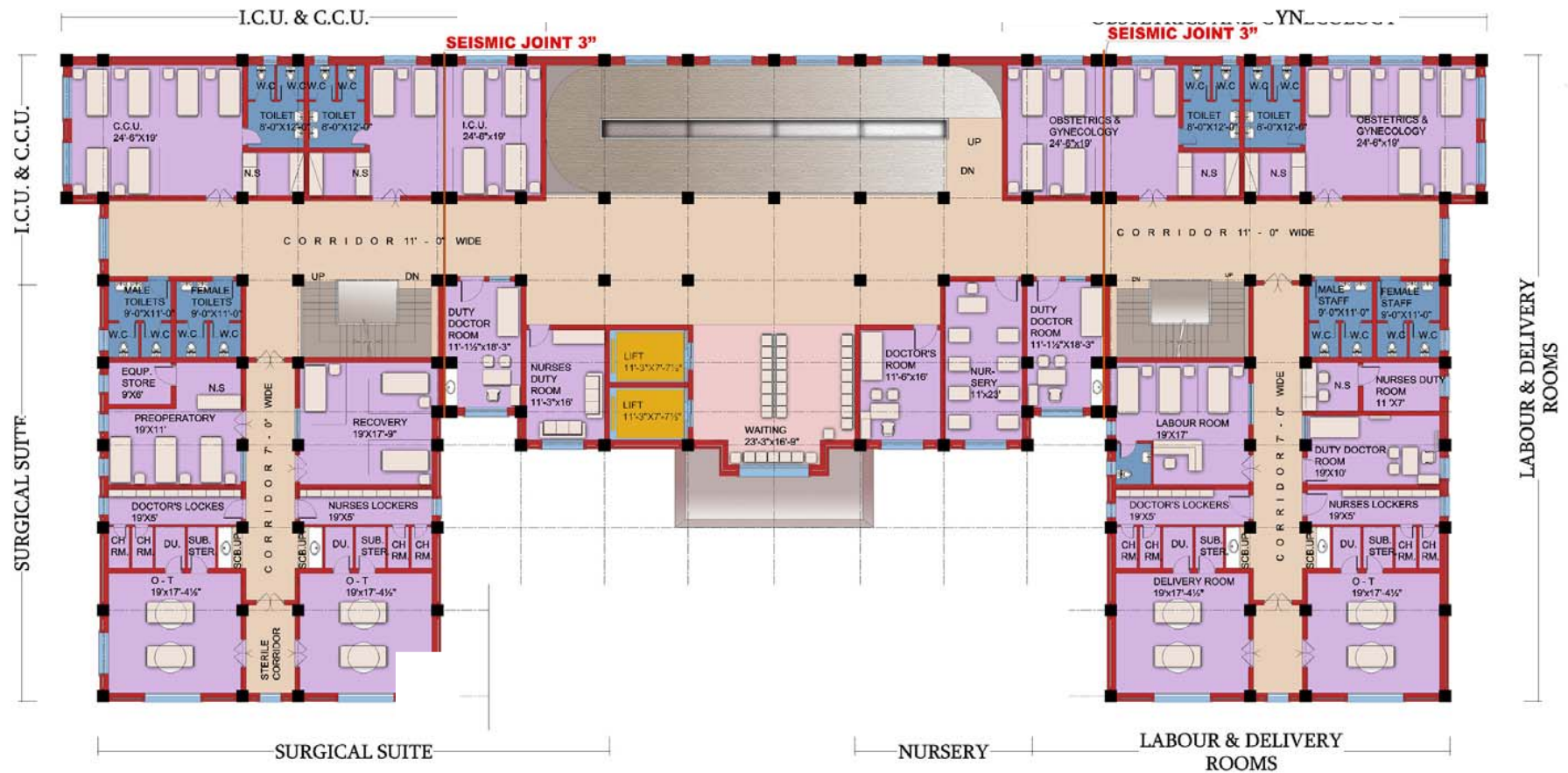

FIRST FLOOR PLAN
COVERED AREA = 12500 Sqft.

General note :
Design may be adjusted due to following parameters

1. Seismic parameters
2. User requirement
3. Site parameters

TYPICAL DESIGN - TEHSIL HEADQUARTER HOSPITAL



HEALTH FACILITIES

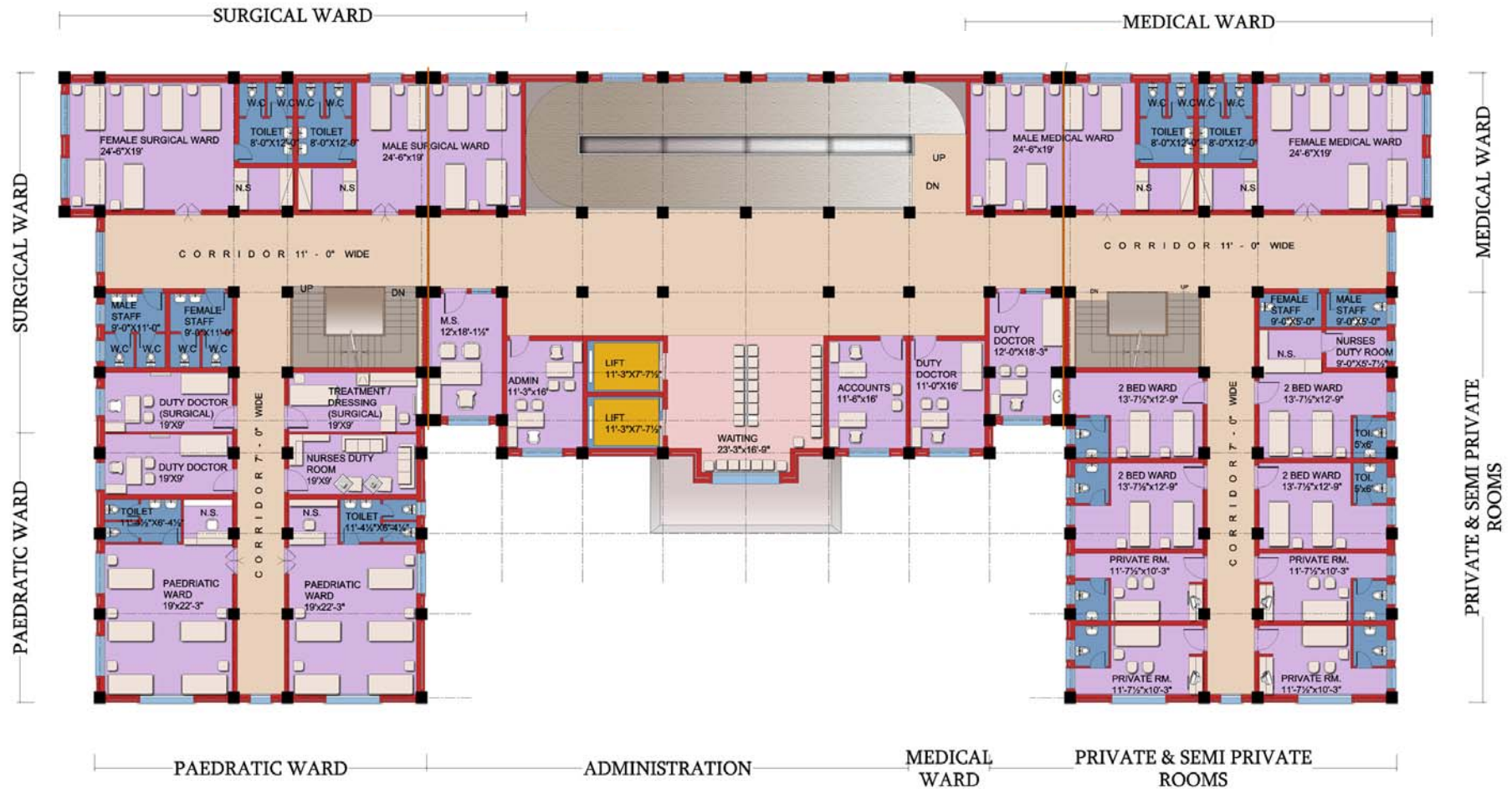

SECOND FLOOR PLAN
COVERED AREA = 12500 Sqft.

General note :
Design may be adjusted due to following parameters

1. Seismic parameters
2. User requirement
3. Site parameters

TYPICAL DESIGN - TEHSIL HEADQUARTER HOSPITAL



HEALTH FACILITIES



TYPICAL DESIGN - TEHSIL HEADQUARTERS HOSPITAL